



PRODUCT SPECIFICATION

Model No : CSD-5622T9/5623T9

| Descriptions: |
|--|
| <ul style="list-style-type: none"> • 0.56 Inch Dual Digits Display • CSD-5622: Common Anode • CSD-5623: Common Cathode • Emitting Color: Super Bright Yellow |



| CUSTOMER APPROVED SIGNATURES | APPROVED BY | CHECKED BY | PREPARED BY |
|---------------------------------|-------------|------------|-------------|
| | | | |

CHINA SEMICONDUCTOR CORPORATION

Address: 2FL. NO.909, Chung-Cheng Road,
Chung-Ho City Taipei Hsien, Taiwan.

Tel: 886-2-2223-9696
Fax: 886-2-2223-9377

OPTO PLUS TECHNOLOGIES CO.,LTD

Address: 696 Shun jiang Rd., Ji Shan St. Shaoxing,
ZheJiang, China

Tel: 86-0575-8623888
Fax: 86-0575-8623112



Model No : CSD-5622/5623T9

■ Features -

1. 0.56 inch (14.2mm) dight height.
2. Case mold type.
3. RoHs compliant.
4. Low power consumption.
5. Easy mounting on P.C. board or socket.

■ Device Selection Guide -

| Part No. | Chip | | Description |
|-------------------|----------------|----------------------------|-----------------------|
| | Material | Emitted Color | |
| CSD-5622T9 | AlGaInP | Super Bright Yellow | Common Anode |
| CSD-5623T9 | AlGaInP | Super Bright Yellow | Common Cathode |

■ Package Dimensions -

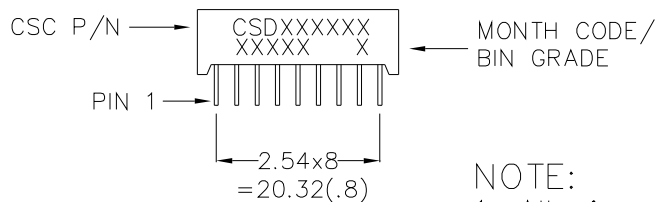
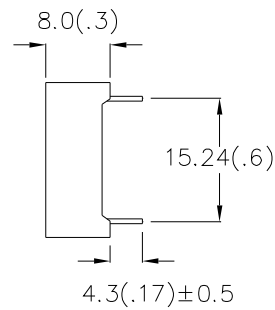
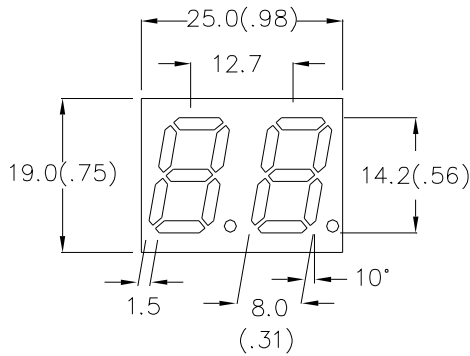

NOTE:

1. All pins are $\phi 0.5(.02)$
2. Dimension in millimeter (inch), and tolerance is $\pm 0.25 (.01)$ unless otherwise noted.



Model No : CSD-5622/5623T9

Internal Circuit Diagrams -

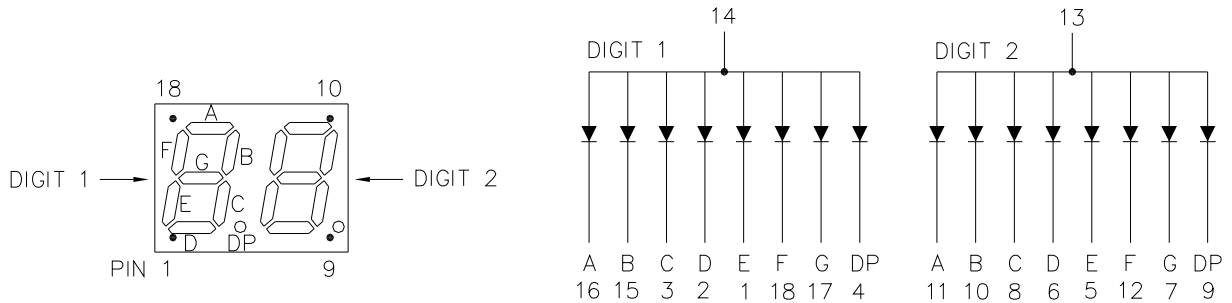

CSD-5622 Common Anode.
(CSD-5623 is Common Cathode.)

Absolute Maximum Rating -

(Ta=25°C)

| Parameter | Symbol | Rating | Unit |
|---|-------------|-----------|-------|
| Power Dissipation Per Dice | Pd | 75 | mW |
| Continuous Forward Current Per Dice | IAF | 25 | mA |
| Peak Current Per Dice | IPF | 90 | mA |
| Derating Linear From 25°C Per Dice | - | 0.33 | mA/°C |
| Reverse Voltage Per Dice | VR | 5 | V |
| Operating Temp. | Topr | -35 ~ +85 | °C |
| Storage Temp. | Tstg | -35 ~ +85 | °C |
| Solder temperature 1/16 inch below seating plane for 3 seconds at 260°C | | | |



Model No : CSD-5622/5623T9

■ Electro-optical Characteristics -

(Ta=25°C)

| Parameter | Symbol | Min. | Typ. | Max. | Unit | Condition |
|-----------------------------------|------------------|------|------|------|------|----------------------|
| Forward Voltage Per Segment | V _F | - | 2.1 | 2.8 | V | I _F =20mA |
| Luminous Intensity Per Segment | I _v | - | 20 | - | mcd | I _F =10mA |
| Peak Emission Wavelength | λ _p | - | 593 | - | nm | I _F =20mA |
| Dominant Wavelength | λ _d | - | 590 | - | nm | I _F =20mA |
| Spectrum Radiation Bandwidth | Δλ | - | 20 | - | nm | I _F =20mA |
| Reverse Current | I _R | - | - | 100 | μA | V _R =5V |
| Luminous Intensity Matching Ratio | I _{V-m} | - | - | 2:1 | - | I _F =10mA |



Model No : CSD-5622/5623T9

■ Typical Electrical / Optical Characteristics Curves -

(Ta = 25°C Unless Otherwise Noted)

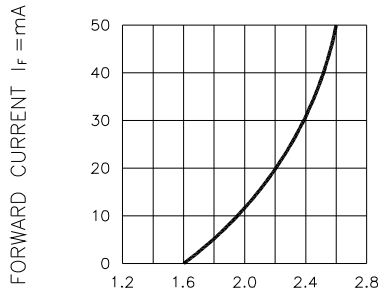

Fig.1 FORWARD CURRENT VS. FORWARD VOLTAGE

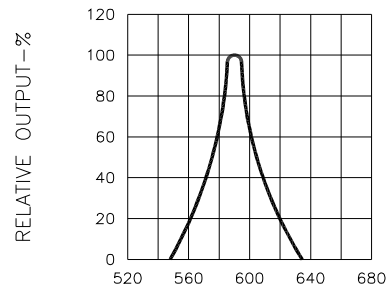

Fig.2 SPECTRAL RESPONSE

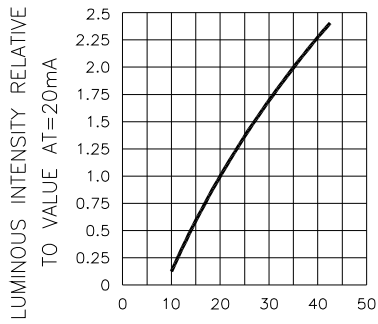

Fig.3 RELATIVE LUMINOUS INTENSITY VS. FORWARD CURRENT

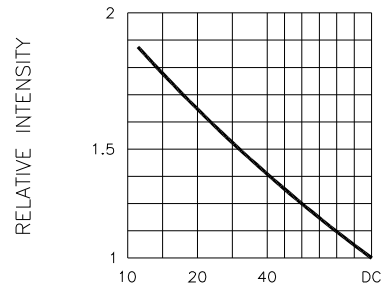

Fig.5 LUMINOUS INTENSITY VS. DUTY CYCLE

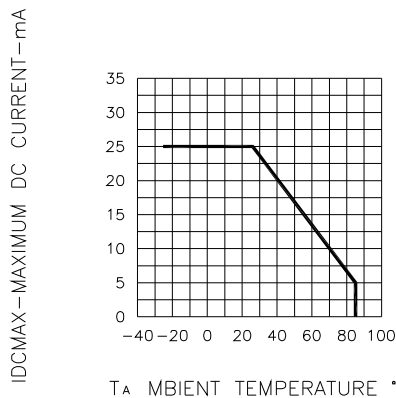

Fig.4 MAXIMUM ALLOWABLE DC CURRENT PER SEGMENT VS. A FUNCTION OF AMBIENT TEMPERATURE

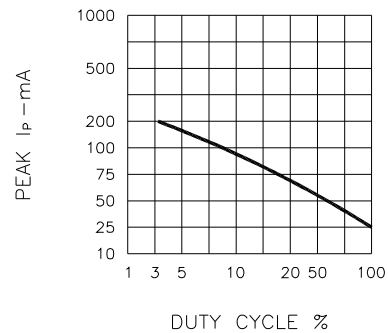

Fig.6 MAX PEAK CURRENT VS. DUTY CYCLE % (REFRESH RATE f=1 KHz)